

# LOW LEVEL ORDER PICKER

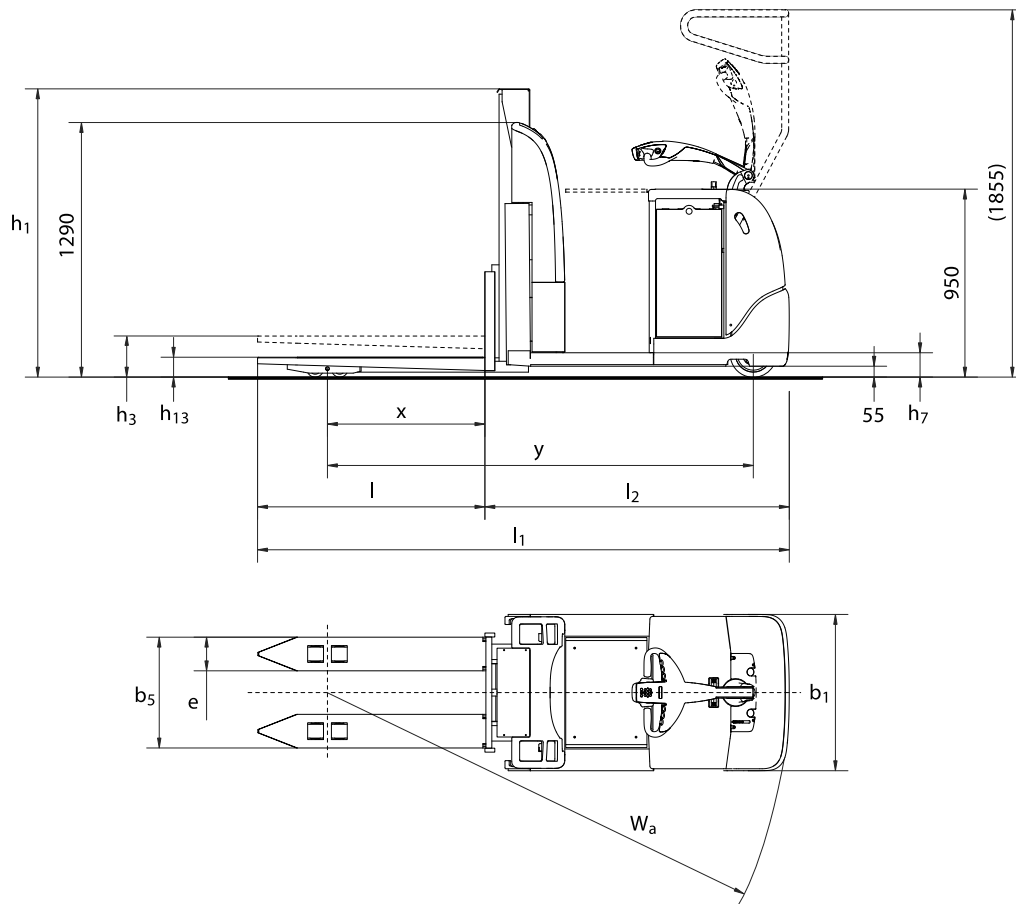

## TEMPO PPC

The ideal alternative for picking from level 1 and 2. Driver and forklift create an ergonomic and efficient combination. 1200 kg.



Mast type	Lift height H	Height of mast lowered h1	Max mast height h4
Standard/Duplex			
Triplex			

# ATLET

[www.atlet.com](http://www.atlet.com)

<b>Distinguishing mark</b>	1.1	Manufacturer			ATLET
	1.2	Manufacturer's type designation			TEMPO PPC
	1.3	Drive: electric (battery or mains), diesel, petrol, fuel gas			Electric
	1.4	Operator type: hand, pedestrian, standing, seated, order-picker			Order-picker
	1.5	Load capacity/rated load	Q	t	1,2
	1.6	Load centre distance	c	mm	600
	1.8	Load distance, centre of load axle to fork	x		650 - 1050
	1.9	Wheelbase	y	mm	1358 + x
<b>Weight</b>	2.1	Service weight		kg	872
	2.2	Axle loading, laden, drive side/load side		kg	970 / 1475
	2.3	Axle loading, unladen, drive side/load side		kg	880 / 420
<b>Tyres, chassis</b>	3.1	Tyres			Vulcollan
	3.2	Tyre size, drive side		mm	Ø 230x90
	3.3	Tyre size, load side		mm	Ø 85x70
	3.4	Dimensions additional wheels (castor wheels)		mm	Ø 150x55
	3.5	Wheels, number front/rear (drive side/load side, x = driven wheels)			1x 1/4
	3.6	Track, drive side	b <sub>10</sub>	mm	
	3.7	Track, load side	b <sub>11</sub>	mm	
<b>Dimensions</b>	4.1	Tilt of mast/fork carriage, forward/backward		Grad	
	4.2	Height, mast lowered	h <sub>1</sub>	mm	1502
	4.3	Free lift	h <sub>2</sub>	mm	
	4.4	Lift height H = h <sub>13</sub> +h <sub>3</sub>	H	mm	950
	4.5	Height, mast extended	h <sub>4</sub>	mm	1502
	4.6	Straddle lift	h <sub>5</sub>	mm	
	4.7	Height of overhead guard (cabin)	h <sub>6</sub>	mm	
	4.8	Seat height/stand height	h <sub>7</sub>	mm	146
	4.10	Height of wheel arms	h <sub>8</sub>	mm	80
	4.11	Additional lift	h <sub>9</sub>	mm	
	4.14	Stand height, elevated	h <sub>12</sub>	mm	
	4.15	Height lowered	h <sub>13</sub>	mm	85
	4.19	Overall length	l <sub>1</sub>	mm	1536 + l
	4.20	Length to face of forks	l <sub>2</sub>	mm	1536
	4.21	Overall width	b <sub>1</sub>	mm	790
	4.21.1	Width over stabilizers		mm	
	4.22	Fork dimensions	s/e/l	mm	65 / 170-175 / 1000-2165
	4.25	Width over forks, min/max	b <sub>5</sub>	mm	540 - 700
	4.26	Distance between wheel arms	b <sub>4</sub>	mm	246 / 266 / 386
	4.28	Reach distance	l <sub>4</sub>	mm	
	4.32	Ground clearance, centre of wheelbase	m <sub>2</sub>	mm	
	4.33	Aisle width with pallet 1000 x 1200, crosswise	A <sub>st</sub>	mm	
	4.34	Aisle width for pallet 800 x 1200, lengthwise	A <sub>st</sub>	mm	
4.35	Turning radius	W <sub>a</sub>	mm	1536 + x	
4.37	Length incl reach legs	l <sub>7</sub>	mm		
<b>Performance data</b>	5.1	Travel speed, laden/unladen		km/h	11,3 / 12,0
	5.2	Lift speed, laden/unladen		m/s	0,18 / 0,22
	5.3	Lowering speed, laden/unladen		m/s	0,14 / 0,01
	5.7	Gradient, laden/unladen		%	9 / 15
	5.9	Acceleration time 0-10 km/h, laden/unladen		s	
	5.10	Service brake: electric, hydraulic			Electric
	5.10.1	Parking brake: electric, hydraulic			Electric
<b>Electric engine</b>	6.1	Drive motor		kW	2,2 AC
	6.2	Lift motor		kW	2,2
	6.4	Battery voltage / Battery capacity		V/Ah	24 / 300-600
	6.5	Battery weight		kg	428
<b>Additional data</b>	8.1	Speed regulation			AC Transistor
	8.2	Operating pressure attachments		bar	160

\* Varies according to battery size

All rights reserved to change above specification